

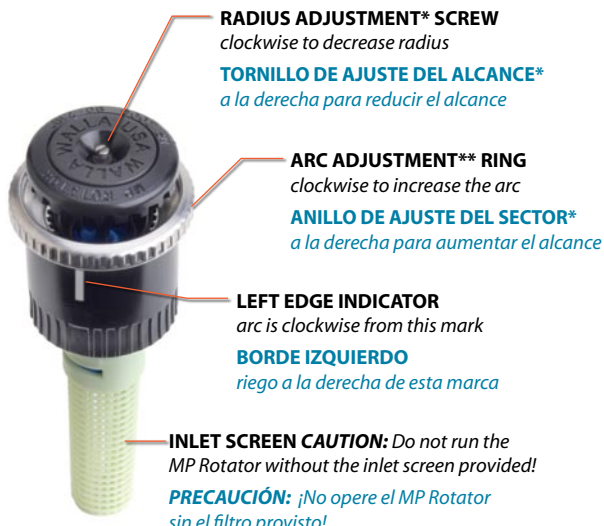

**Easy radius adjustment**  
*El alcance se ajusta fácilmente*



**Easy arc adjustment**  
*El sector se ajusta fácilmente*



\*Built-in slip clutch prevents damage from over adjustment.

\*Mecanismo dentado integrado para prevenir daños al ajustar.

\*\*Built-in ratchet permits left edge alignment.

\*\*El mecanismo dentado integrado permite ajustar el borde izquierdo.



**MP ROTATOR®**

## THE IDEAL 8-30' SOLUTION

**Maintain Matched Precipitation — Any Arc, Any Radius.**  
All MP Rotator® sprinklers can be combined on the same zone for greater design and installation flexibility.

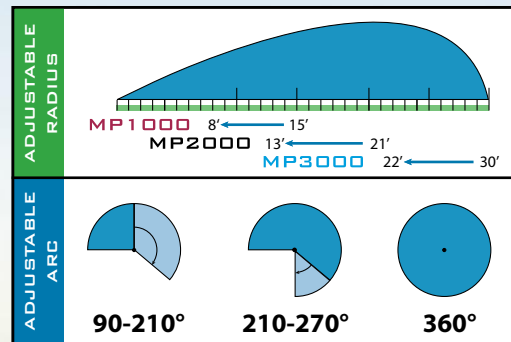

### WATER CONSERVATION

MP Rotators are more efficient\* than sprays because they apply water more slowly and evenly. In fact, you **use 30% less water** even though you run MP Rotators about twice as long as sprays. See below for comparison at 30 PSI with half-circle operation:

|                         |  |
|-------------------------|--|
| <b>15H Spray Nozzle</b> | 1.85 gpm x 10 minute run time = 18.5 gallons |
| <b>MP2000 90-210°</b>   | 0.63 gpm x 20 minute run time = 12.6 gallons |
| <b>SAVINGS</b>          | <b>= 5.9 gallons or 31.9%</b>                |

### LOWER SYSTEM COST

The good news about applying water more slowly and evenly is that MP Rotators lower your system costs. You can run more heads off your water meter and reduce the number of zones required. In many cases, you can use smaller pipe. See below for comparison at 30 PSI with half-circle operation:

| AWWA<br>Meter Size | Max. Safe<br>Flow (GPM) | Loss<br>(PSI) | Max. #<br>15H Sprays | Max. #<br>MP2000s |
|--------------------|-------------------------|---------------|----------------------|-------------------|
| 5/8"               | 15                      | 8.3           | 8                    | 24                |
| 3/4"               | 22                      | 7.9           | 12                   | 35                |
| 1"                 | 37                      | 8.3           | 20                   | 59                |

\*Visit [www.mprotator.com](http://www.mprotator.com) for documentation.



848 Airport Road, Walla Walla, WA 99362-2271, U.S.A.  
Tel: 509.525.7660 — Fax: 509.525.7907  
info@mprotator.com — [www.mprotator.com](http://www.mprotator.com)



# MP ROTATOR®

## MP LEFT STRIP

| PSI | UNADJUSTED |          | ADJUSTED |          |
|-----|------------|----------|----------|----------|
|     | RADIUS     | WXL      | RADIUS   | WXL      |
|     | GPM        | feet     | GPM      | feet     |
| 30  | .19        | 5 x 15   | .14      | 4 x 12   |
| 40  | .22        | 5.5 x 16 | .16      | 4.5 x 13 |
| 50  | .25        | 6 x 17   | .18      | 5 x 14   |



## MP SIDE STRIP

| PSI | UNADJUSTED |          | ADJUSTED |          |
|-----|------------|----------|----------|----------|
|     | RADIUS     | WXL      | RADIUS   | WXL      |
|     | GPM        | feet     | GPM      | feet     |
| 30  | .38        | 5 x 30   | .27      | 4 x 24   |
| 40  | .44        | 5.5 x 32 | .32      | 4.5 x 26 |
| 50  | .49        | 6 x 34   | .36      | 5 x 28   |



## MP RIGHT STRIP

| PSI | UNADJUSTED |          | ADJUSTED |          |
|-----|------------|----------|----------|----------|
|     | RADIUS     | WXL      | RADIUS   | WXL      |
|     | GPM        | feet     | GPM      | feet     |
| 30  | .19        | 5 x 15   | .14      | 4 x 12   |
| 40  | .22        | 5.5 x 16 | .16      | 4.5 x 13 |
| 50  | .25        | 6 x 17   | .18      | 5 x 14   |



| MP1000*     |     |          |      |
|-------------|-----|----------|------|
| Arc Setting | PSI | Rad. Ft. | GPM  |
| 90°         | 30  | 12.0     | 0.16 |
|             | 40  | 13.5     | 0.19 |
|             | 50  | 14.5     | 0.21 |
|             | 55  | 15.0     | 0.22 |
| 180°        | 30  | 12.0     | 0.32 |
|             | 40  | 13.5     | 0.37 |
|             | 50  | 14.5     | 0.41 |
|             | 55  | 15.0     | 0.43 |
| 210°        | 30  | 12.0     | 0.37 |
|             | 40  | 13.5     | 0.43 |
|             | 50  | 14.5     | 0.48 |
|             | 55  | 15.0     | 0.50 |

|    |      |      |
|----|------|------|
| 30 | 12.0 | 0.65 |
| 40 | 13.5 | 0.75 |
| 50 | 14.5 | 0.84 |
| 55 | 15.0 | 0.87 |

| MP2000*     |     |          |      |
|-------------|-----|----------|------|
| Arc Setting | PSI | Rad. Ft. | GPM  |
| 90-210°     | 30  | 18       | 0.33 |
|             | 40  | 20       | 0.40 |
|             | 50  | 22       | 0.44 |
|             | 55  | 22       | 0.47 |
|             | 30  | 17       | 0.63 |
| 90-210°     | 40  | 19       | 0.74 |
|             | 50  | 21       | 0.83 |
|             | 55  | 21       | 0.85 |
|             | 30  | 17       | 0.74 |
|             | 40  | 19       | 0.86 |
| 210-270°    | 50  | 21       | 0.97 |
|             | 55  | 21       | 1.01 |
|             | 30  | 17       | 0.95 |
|             | 40  | 19       | 1.10 |
|             | 50  | 21       | 1.23 |
| 360°        | 55  | 21       | 1.30 |
|             | 30  | 17       | 1.27 |
|             | 40  | 19       | 1.47 |
|             | 50  | 21       | 1.64 |
|             | 55  | 21       | 1.70 |

| MP3000**    |     |          |      |
|-------------|-----|----------|------|
| Arc Setting | PSI | Rad. Ft. | GPM  |
| 90-210°     | 30  | 27       | 0.74 |
|             | 40  | 30       | 0.86 |
|             | 50  | 30       | 0.96 |
|             | 55  | 30       | 1.01 |
|             | 30  | 27       | 1.58 |
| 90-210°     | 40  | 30       | 1.82 |
|             | 50  | 30       | 2.04 |
|             | 55  | 30       | 2.13 |
|             | 30  | 27       | 1.84 |
|             | 40  | 30       | 2.12 |
| 210-270°    | 50  | 30       | 2.37 |
|             | 55  | 30       | 2.49 |
|             | 30  | 27       | 2.37 |
|             | 40  | 30       | 2.73 |
|             | 50  | 30       | 3.06 |
| 360°        | 55  | 30       | 3.22 |
|             | 30  | 27       | 3.15 |
|             | 40  | 30       | 3.64 |
|             | 50  | 30       | 4.07 |
|             | 55  | 30       | 4.27 |

Radius measured on a 4" high riser.

\*To obtain full radius reduction for the MP1000 and MP2000, operate at a maximum of 30 PSI.

\*\* When operating the MP3000 at full radius reduction maintain a minimum pressure of 40 PSI to assure reliable operation.

| MP CORNER   |     |          |      |
|-------------|-----|----------|------|
| Arc Setting | PSI | Rad. Ft. | GPM  |
| 45°         | 30  | 12.0     | 0.17 |
|             | 40  | 13.5     | 0.19 |
|             | 50  | 15.5     | 0.22 |
|             | 55  | 15.0     | 0.23 |
| 90°         | 30  | 12.0     | 0.34 |
|             | 40  | 13.5     | 0.39 |
|             | 50  | 15.5     | 0.43 |
|             | 55  | 15.0     | 0.46 |
| 105°        | 30  | 12.0     | 0.39 |
|             | 40  | 13.5     | 0.45 |
|             | 50  | 15.5     | 0.51 |
|             | 55  | 15.0     | 0.53 |

### MP CORNER EXAMPLE @ 45°

